



# WC A PAVIMENTO 0021P

Articolo	Item	
<b>SD0110020001-SATINATO</b>	<b>SD0110020001-SATIN</b>	    
<b>SD0110020101-LUCIDO</b>	<b>SD0110020101-HIGH POLISHED</b>	
WC a pavimento in acciaio inox AISI 304. <ul style="list-style-type: none"> <li>• Spessore 1,5 mm</li> <li>• Scarico universale parete/pavimento</li> <li>• Finitura Satinata/lucida</li> <li>• Fornito con curva 90° Ø 100-110mm</li> <li>• 2 pannelli tecnici con viti antivandalo</li> <li>• Conforme alla norma EN 997</li> </ul>	WC floor mounted Type 304 SS made <ul style="list-style-type: none"> <li>• Thickness 1,5mm</li> <li>• Double floor/wall drainage</li> <li>• Satin or High polish finish.</li> <li>• Complete with 90° pipe Ø 100-110mm</li> <li>• 2 side panels with antivandalic screws</li> <li>• With overflow hole on request</li> <li>• Comply to European std. EN 997</li> </ul>	

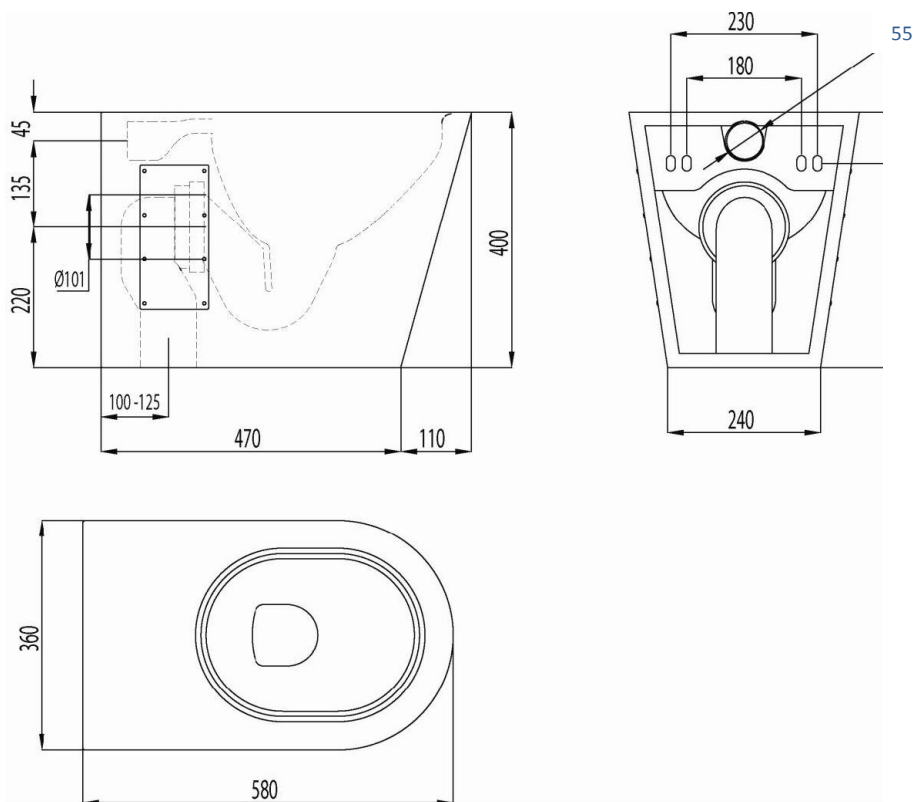

Misure, quote e specifiche non sono vincolanti e l'azienda si riserva di modificarle in qualunque momento anche senza preavviso. Non rilevare quote dai disegni